

SP54

PARTITION WALL SYSTEM

Assembly guide

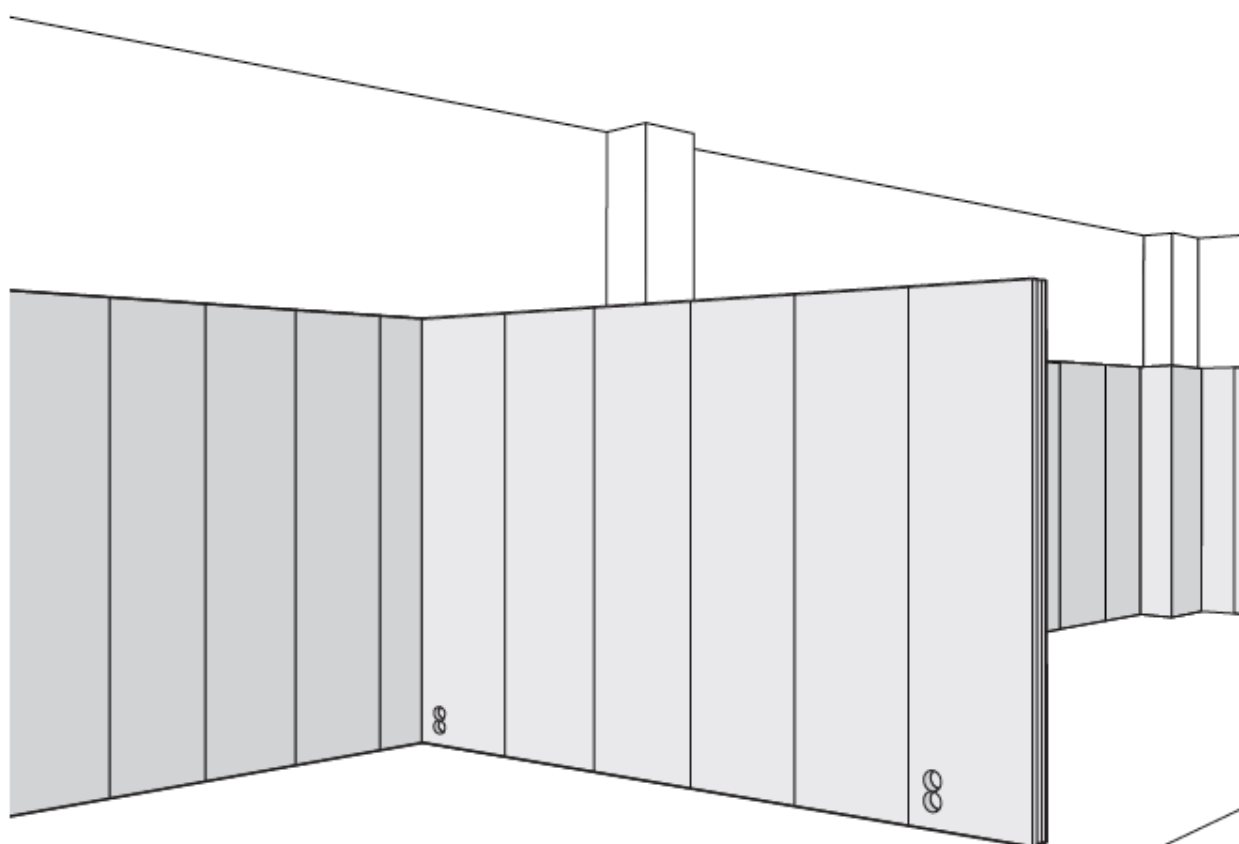

Panel handling - Note! Protect the panels from water and any dampness from the floor. The relative air humidity should not exceed 70%. To avoid cracking walls later on, remove all wrapping and let the panels acclimatise for a few days, on location, prior to installation. The air conditioning should be switched on.

PARTITION WALL SYSTEM

THE BACK-WALL

To use all floor space, install the panels directly to the perimeter wall.
Note! Think about creating functional solutions with the pillars if they merge into the room-sets.

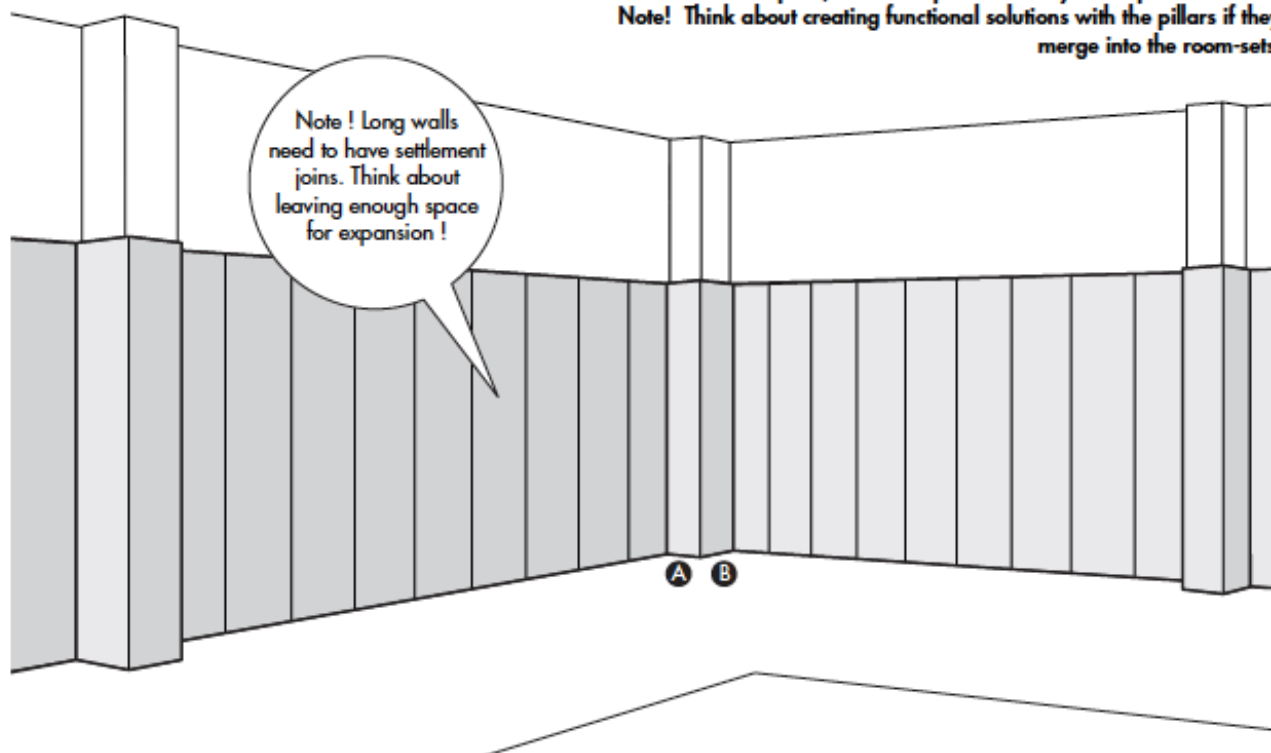

- 1** Reference point - corner pillar.
 Take measurements for T-profiles & panels.



- 2** Cut the T-profile and drill extra holes.

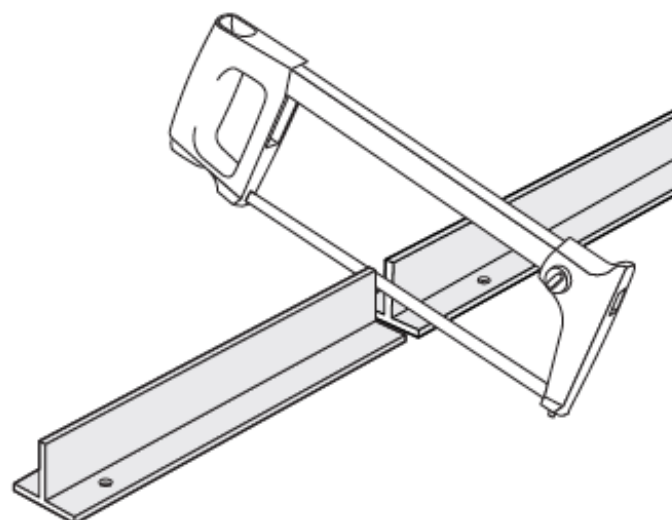
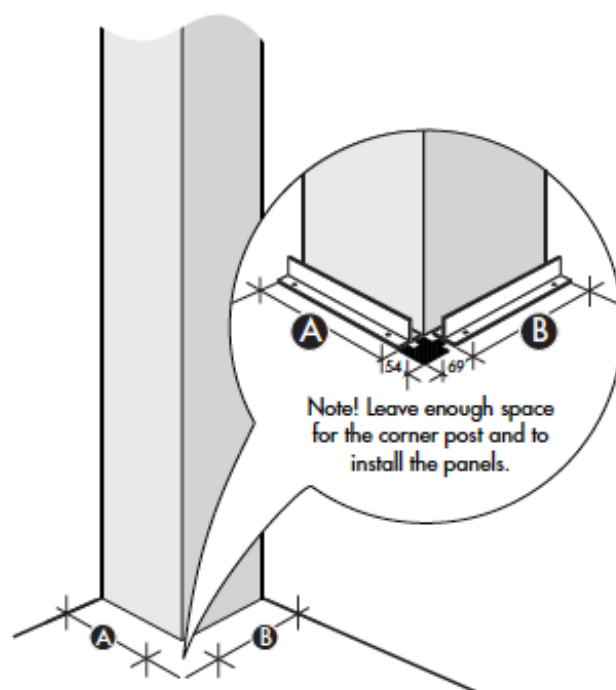

- 3** Check the T-profile level, drill holes into the floor and attach with screws.

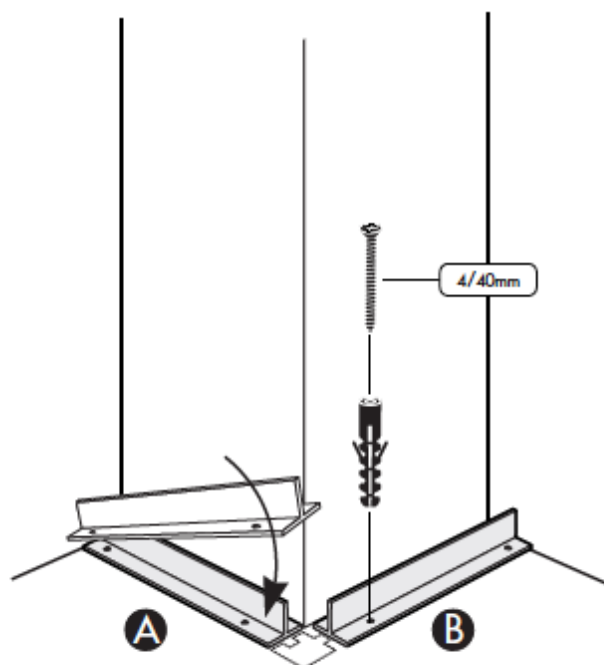

- 4** Cut the panels for the pillar according to your measurements from step 1

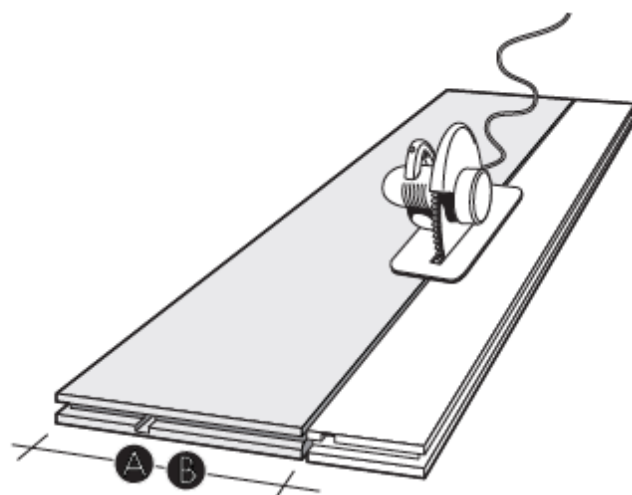

- 5** Put the panel onto the T-profile, insert the tongue into the groove and add foam-points.

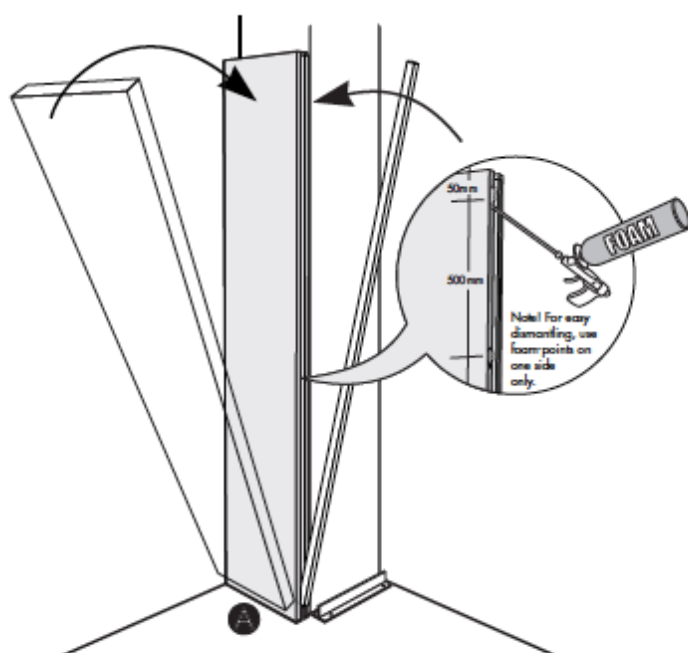

- 6** Install the corner post.

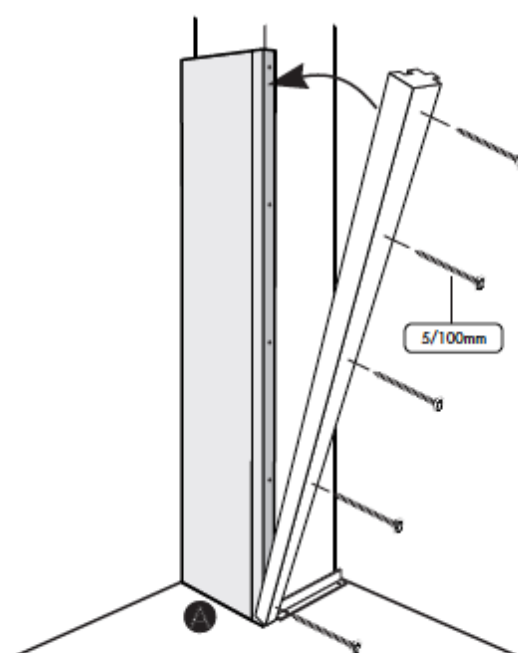

- 7** Add foam-points to the panel, put it onto the T-profile and attach it to the corner post.

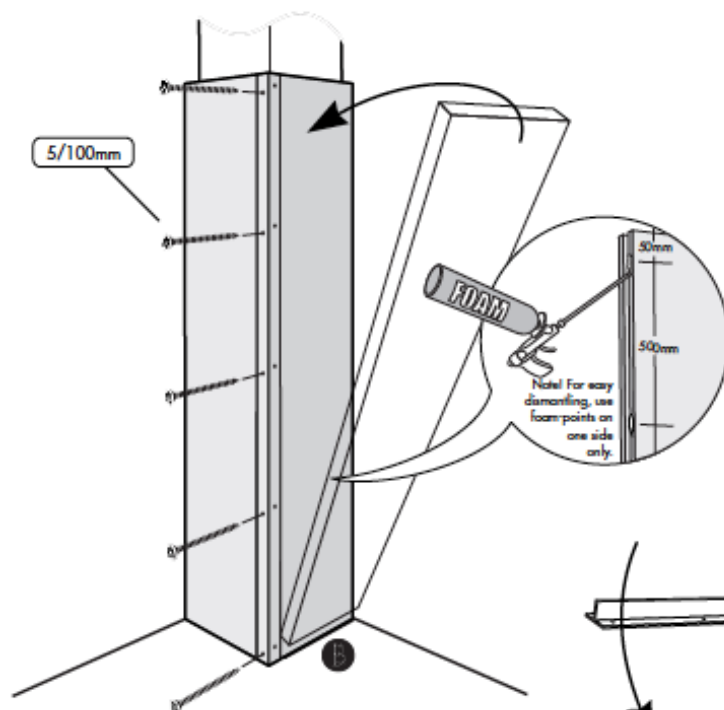

- 8** Install the T-profile along the back-wall, check the level, drill holes and attach with screws.

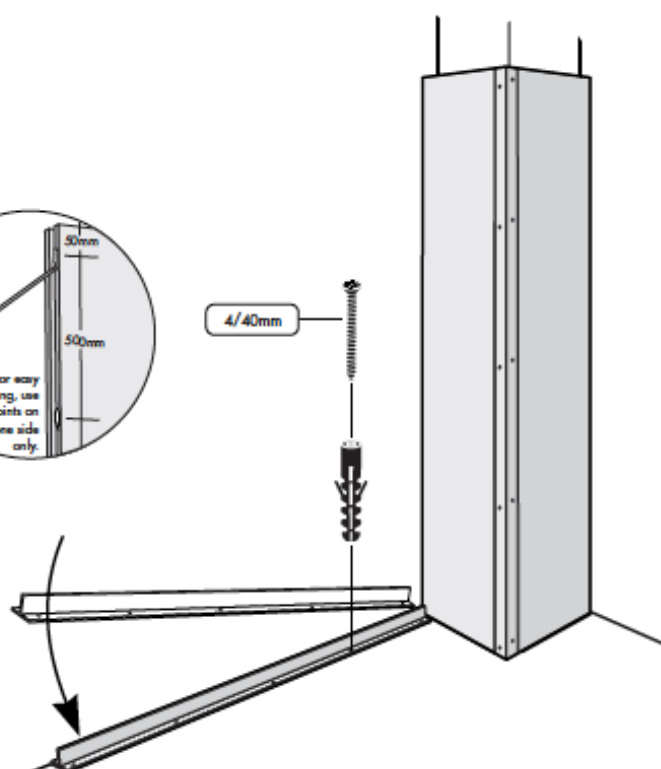

- 9** Attach the wooden tongue.

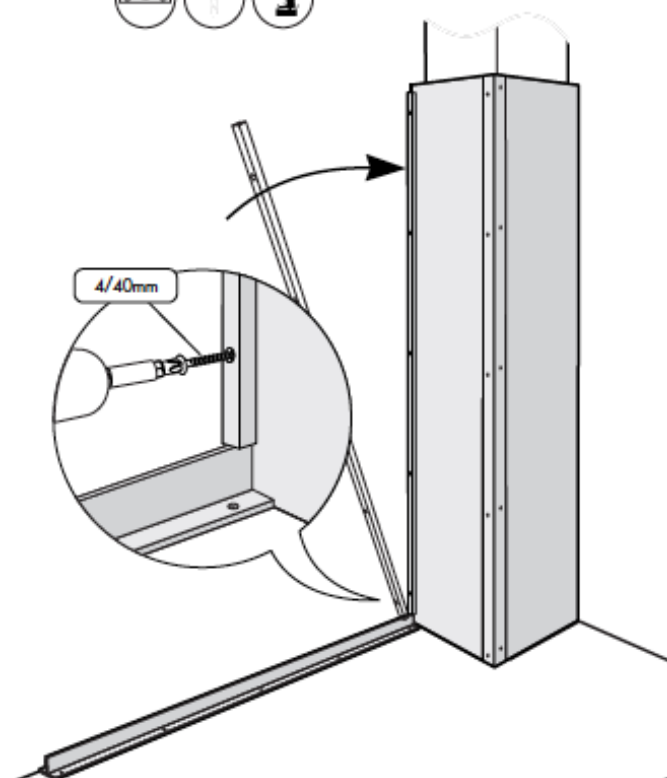

- 10** Put the panel onto the T-profile, add foam-points and press it onto the tongue.

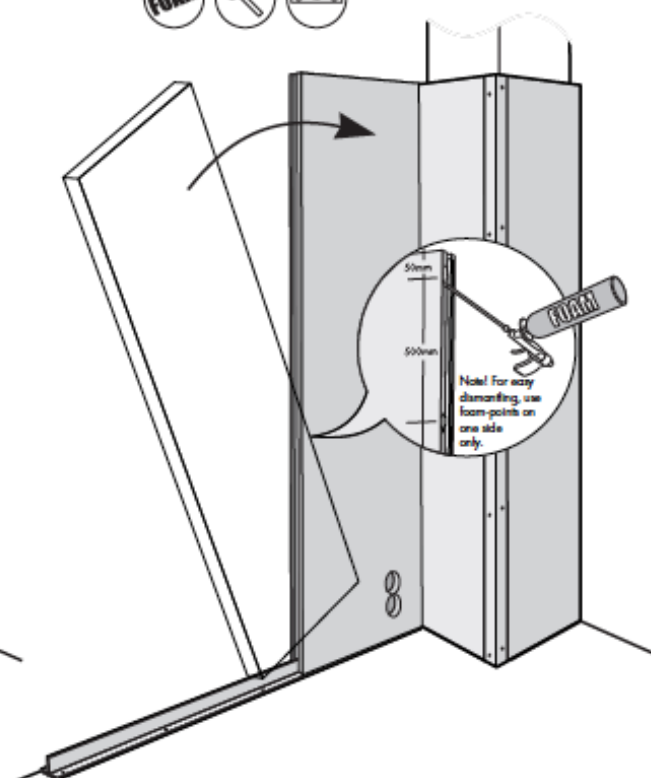

- 11** Insert the tongue into the groove.

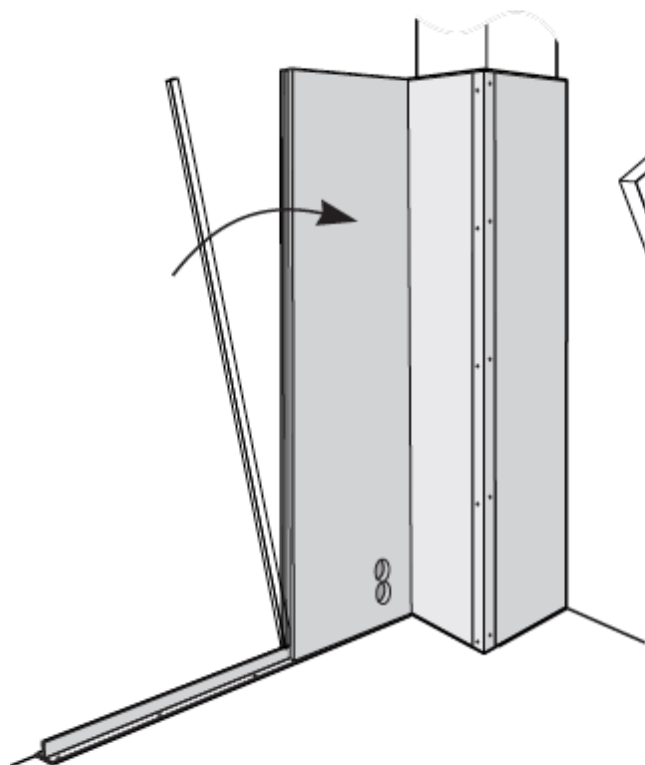

- 12** To finish the back-wall installation, repeat **11** & **12** If necessary, cut the last panel to fit.

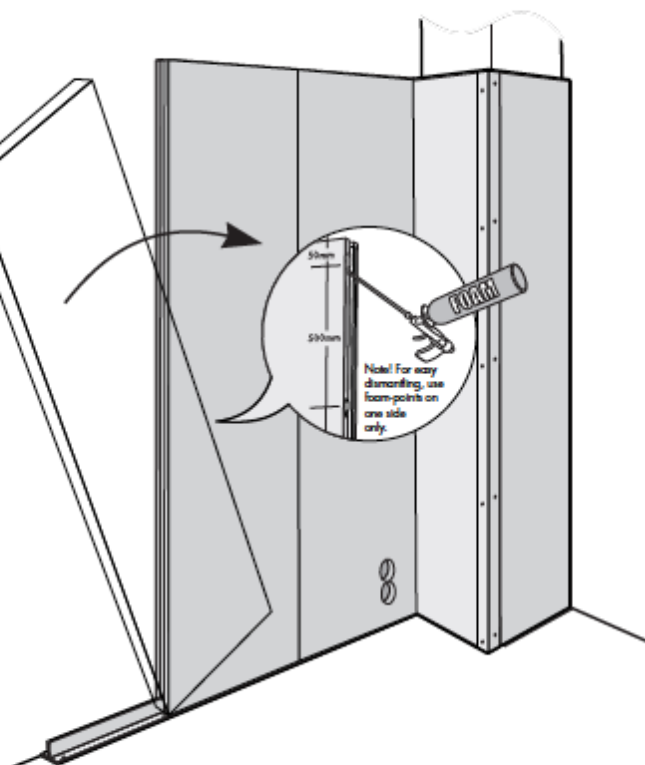

- 13** Secure the panels with (27cm) anchoring straps in the upper groove.



4/40mm

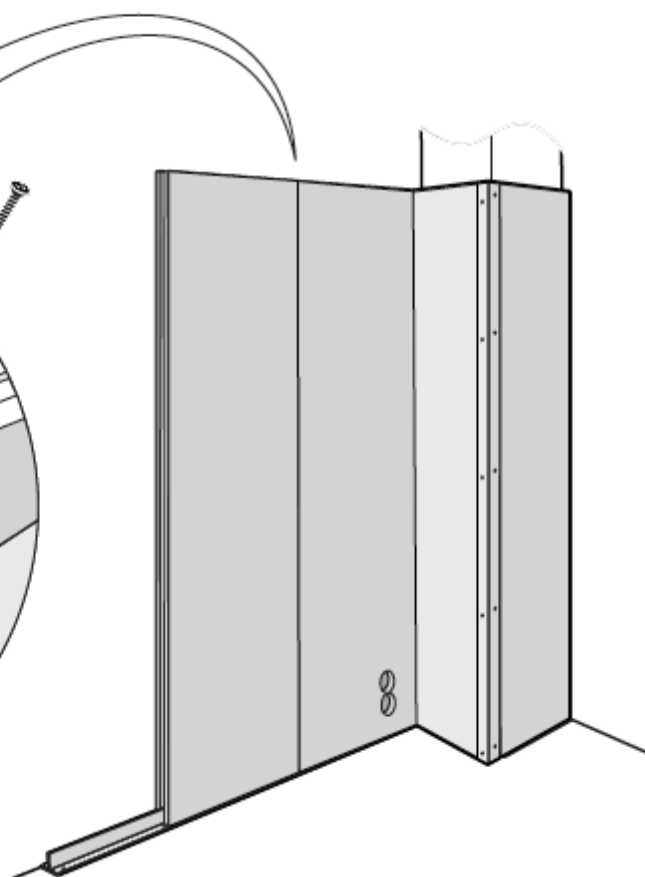
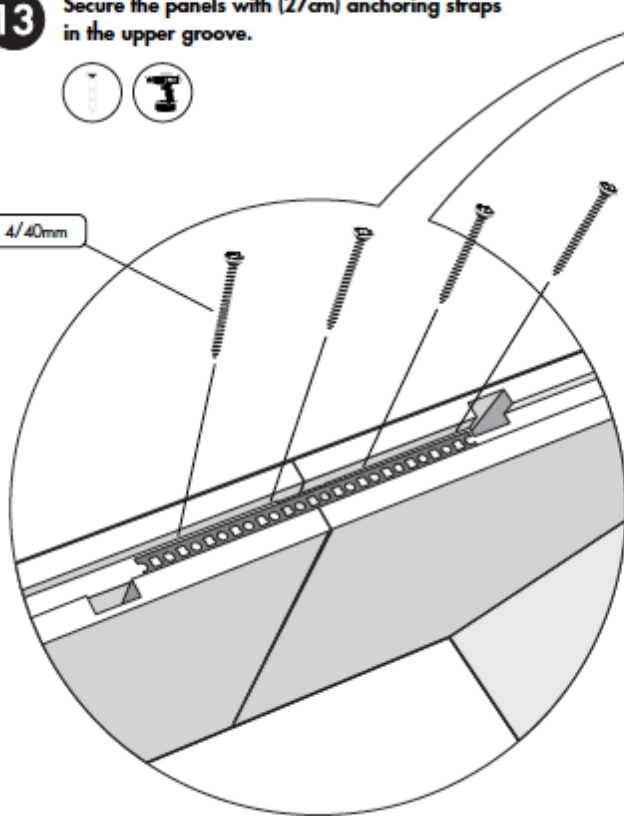

PARTITION WALL SYSTEM

THE DIVIDING-WALL

To stabilize the dividing-wall, always use a T-wall and / or a wall support that connects onto the grid ceiling.

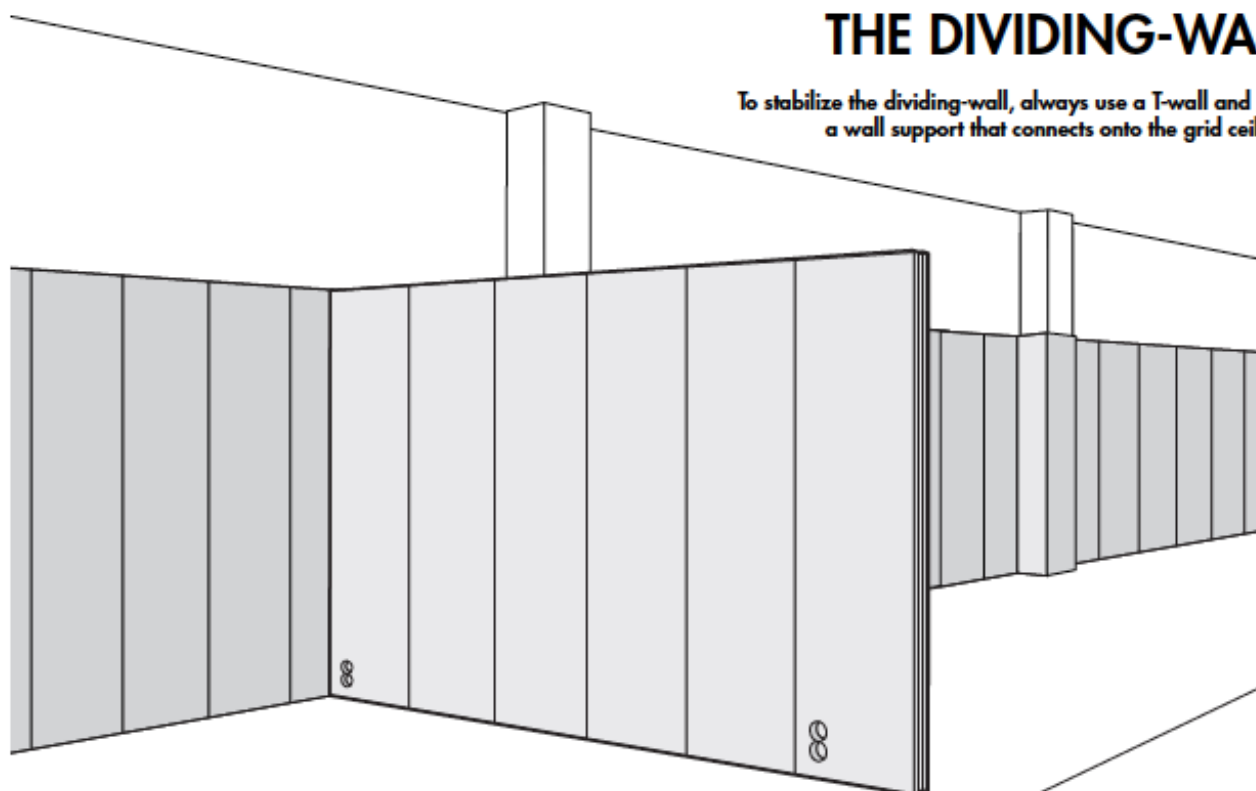

- 1** Install the dividing-wall starting with the T-profile.
Take measurements from a construction pillar or wall.

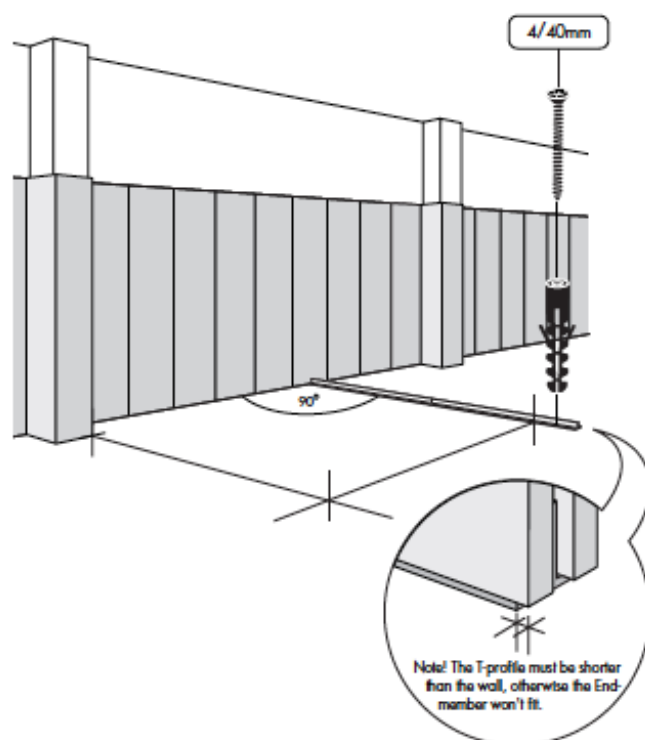

- 2** Install the wooden tongue.

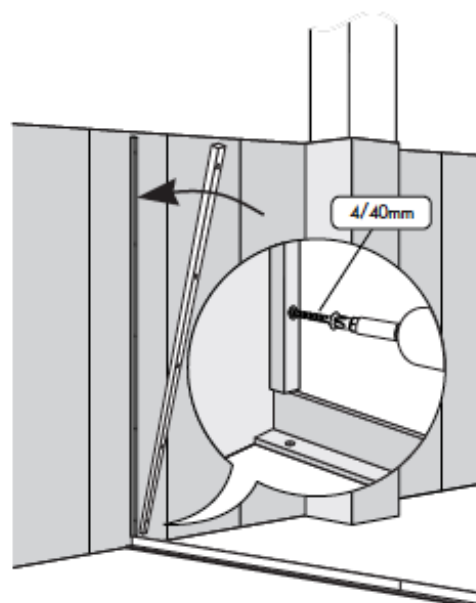

- 3** Put the panel onto the T-profile, add foam-points and press it onto the tongue.

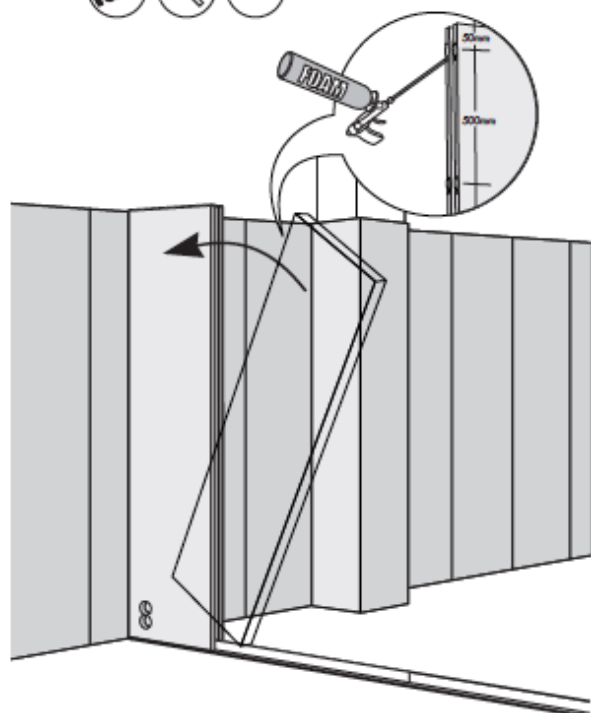

- 4** Insert the tongue into the groove.

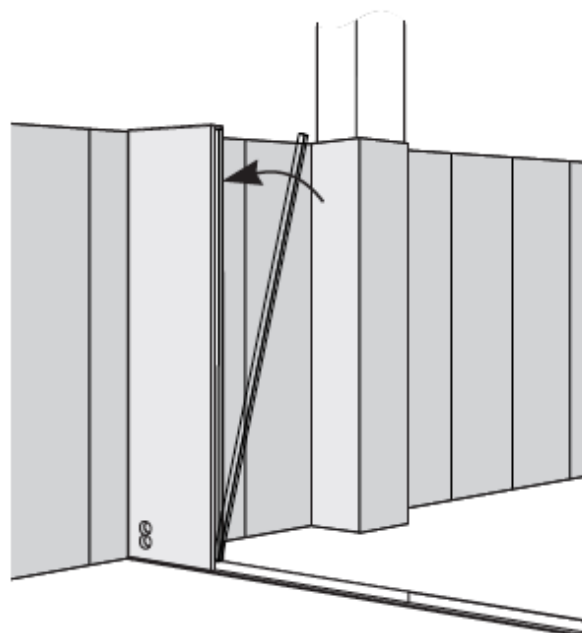

- 5** To finish the dividing-wall installation, repeat 3 & 4. If necessary, cut the last panel to fit.

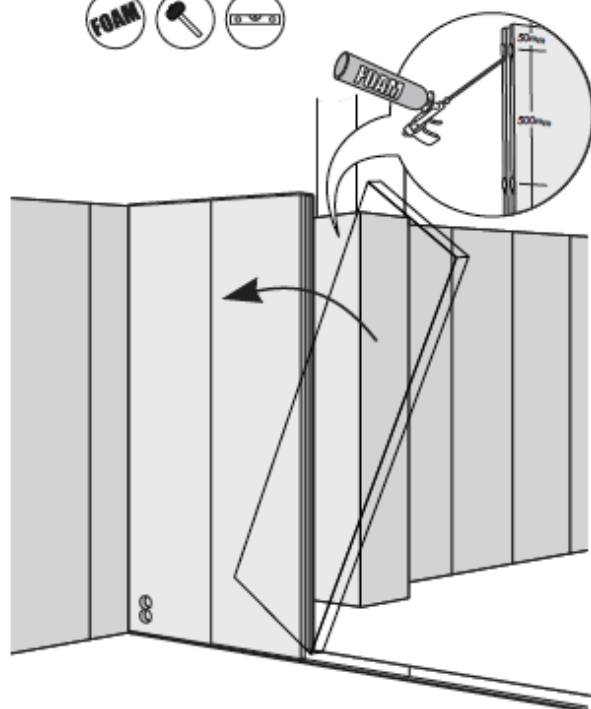

- 6** Secure the last panel to the T-profile and secure all panels with (27cm) anchoring straps in the upper groove.

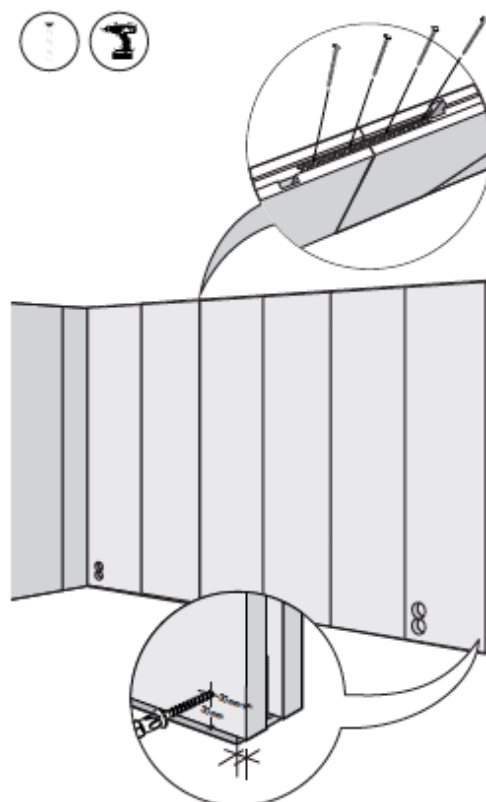

PARTITION WALL SYSTEM ACCESSORIES

- 1** Leveling strips.
Can easily be cut down to size.

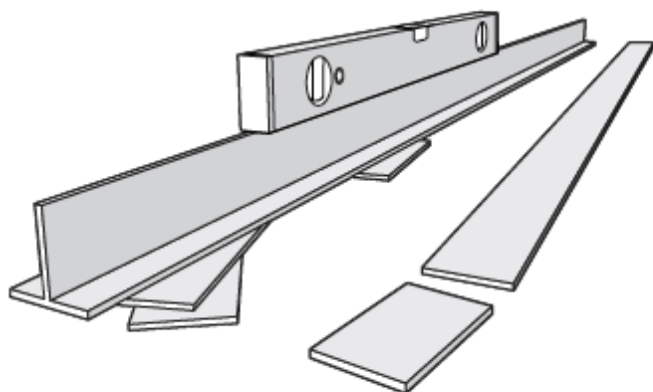

- 2** Wall support.

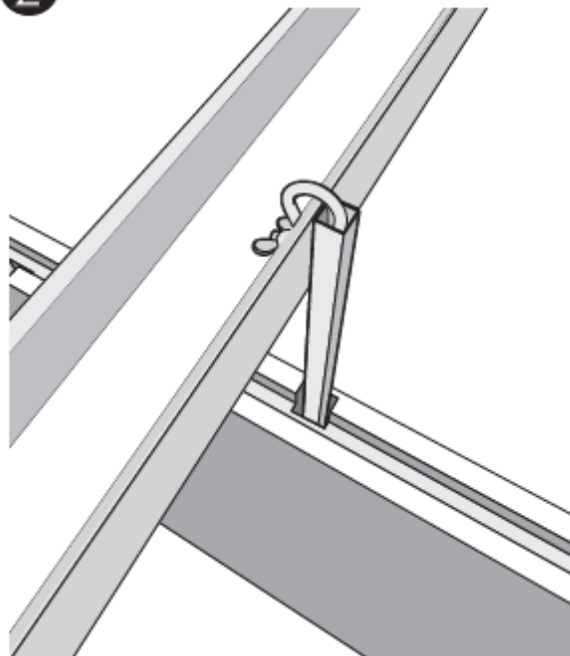

- 3** Cable duct to conceal cables.

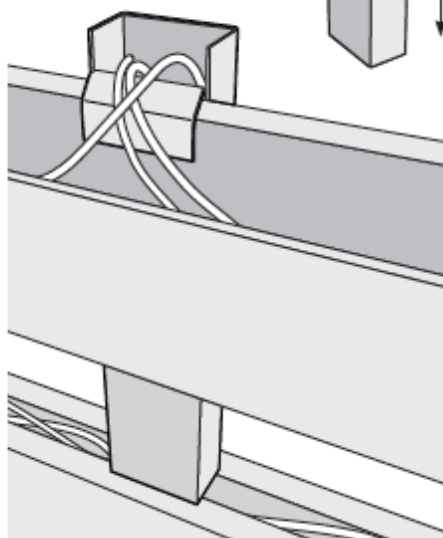
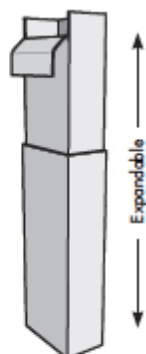

- 4** Earthquake bracket.

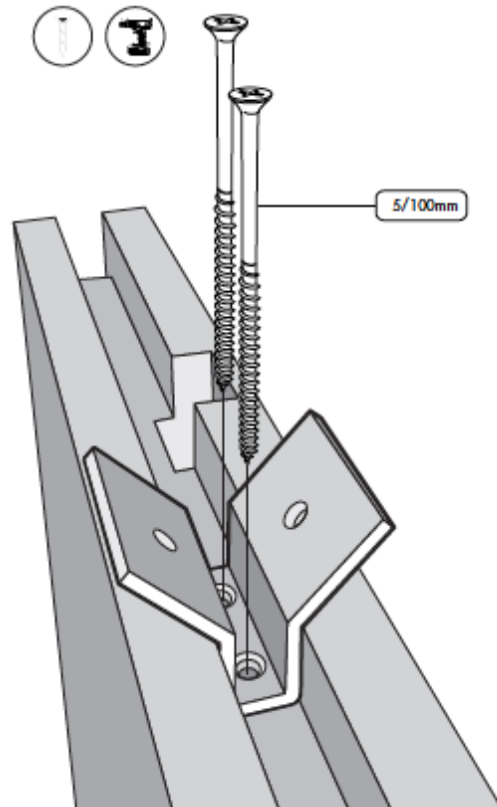

- 5** Use glue to install the end members.

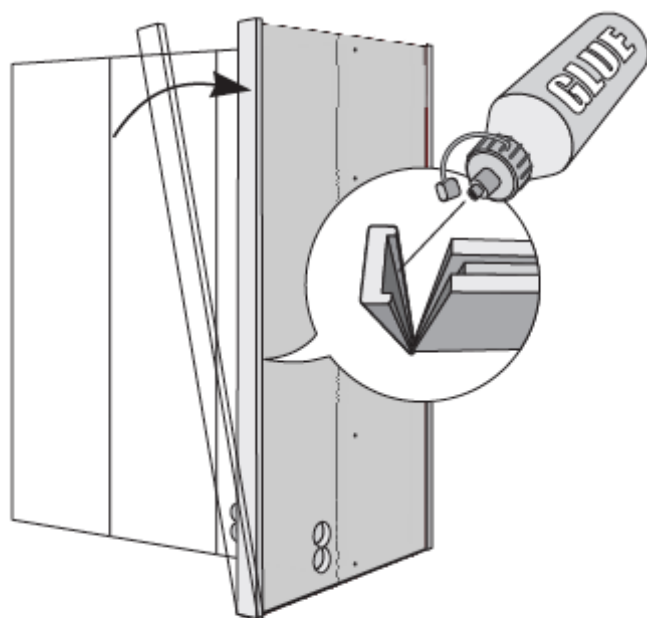

- 6** Secure the panels with anchoring straps (27 cm) in the upper groove.

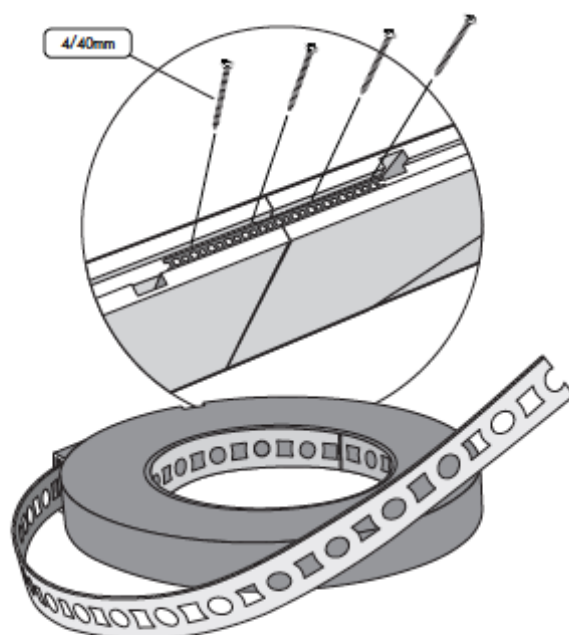

- 7** Foam & Glue

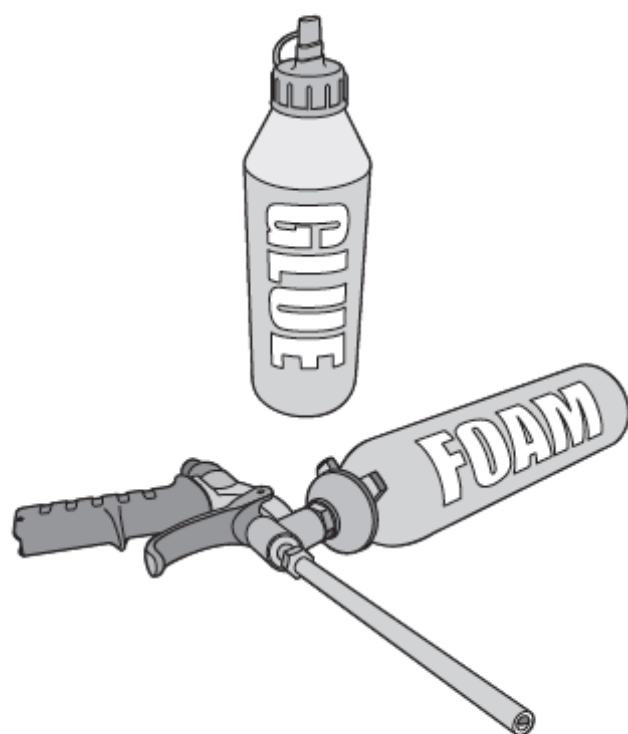

- 8** Screws & Dowels.

4/40mm For T-profiles.



4/40mm For Wooden tongues, T-profiles & Anchoring straps.



5/50mm For Kitchen cabinets.



5/100mm For Corner posts - 45°, 90° & Earthquake brackets.

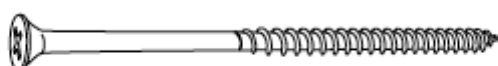

PARTITION WALL SYSTEM SURFACE TREATMENT

- 1** For easy surface treatment, use only as much plaster filling as necessary. One sanding is sufficient to create a smooth and even surface.

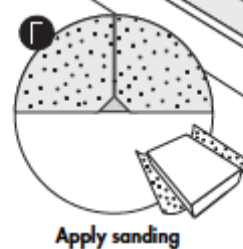
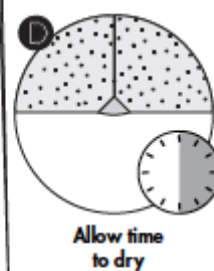
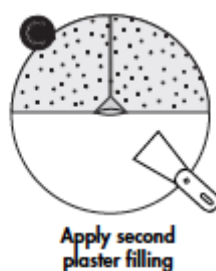
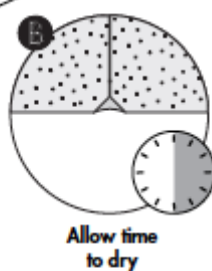
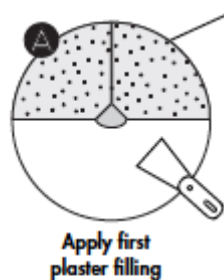

- 2** Put up glass-fibre wall paper.

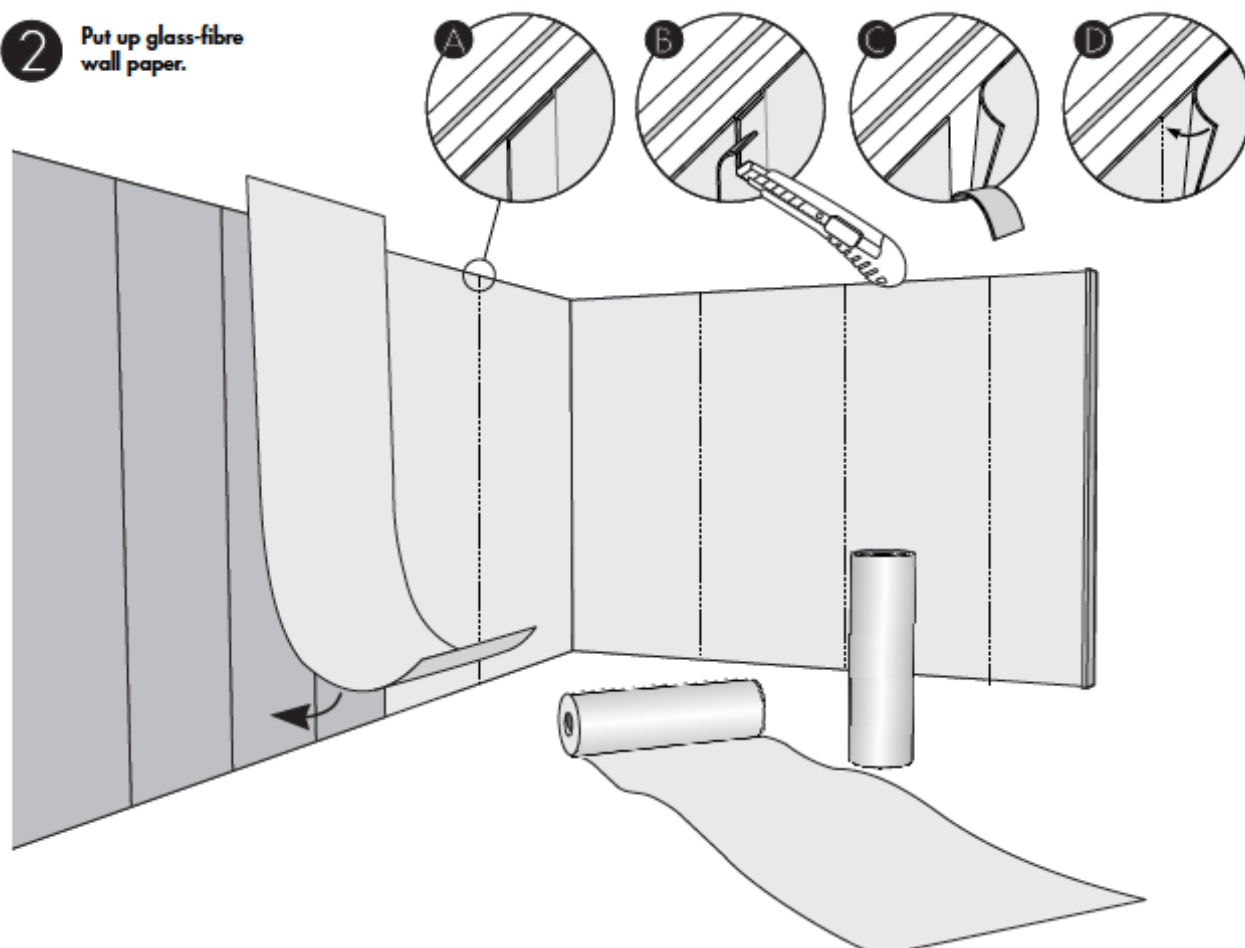

PARTITION WALL SYSTEM TIPS & ADVICE

- 1** Panel handling - Note! Protect the panels from water and any dampness from the floor. The relative air humidity should not exceed 70%. To avoid cracking walls later on, remove all wrapping and let the panels acclimatise for a few days, on location, prior to installation. The air conditioning should be switched on.

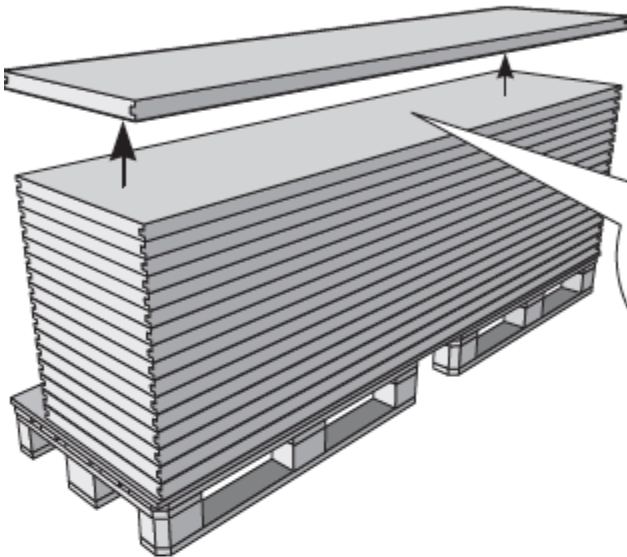

There can still be some grains left from production between the panels. To avoid surface damage, always lift them from the pile.

- 2** If needed, use a protecting corner-post and a rubber mallet for assembly.

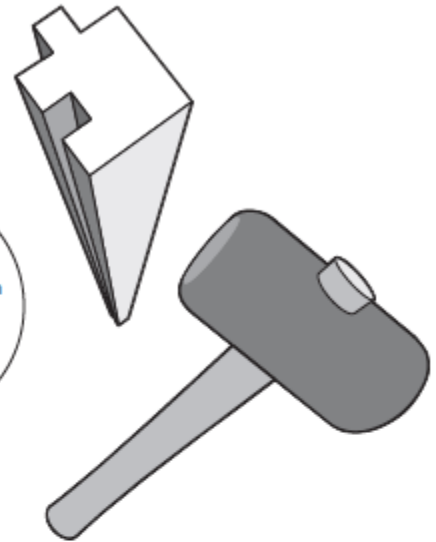

- 3** For easy dismantling and reuse later on, use foam-points approx. every 50cm.

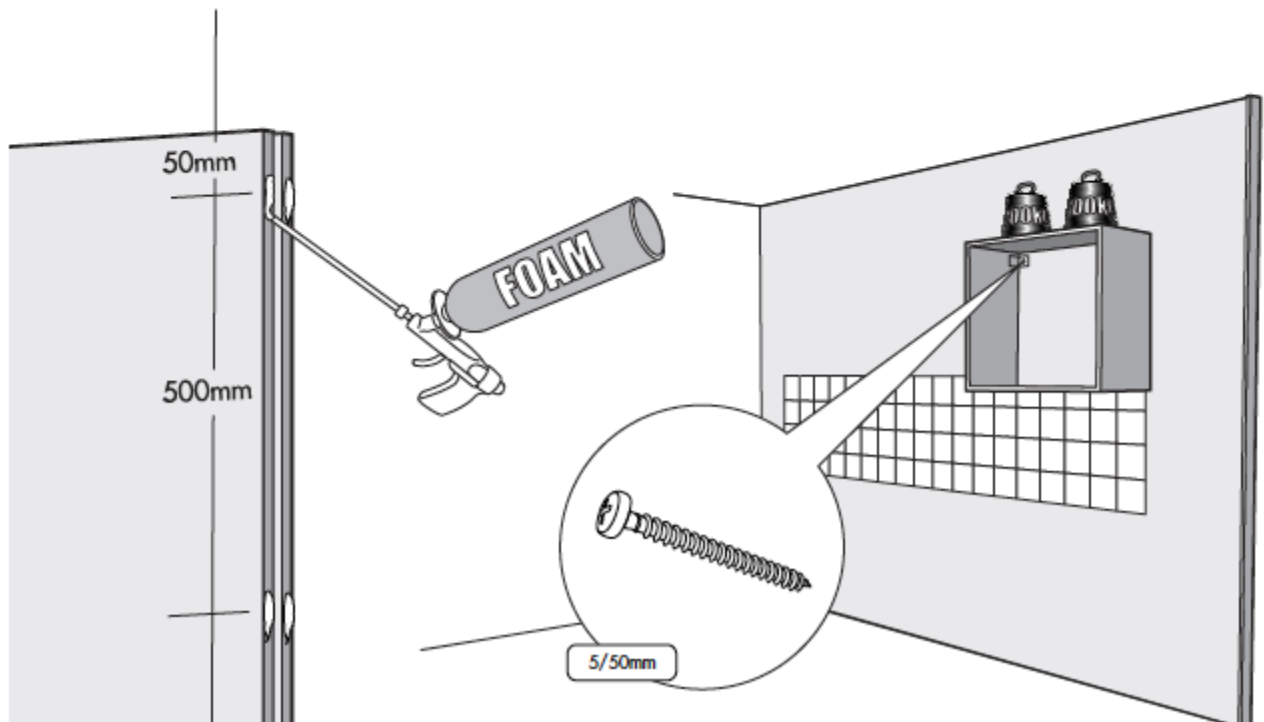

- 4** Weight tolerance of partition-wall. Note! the wall has to be stable enough and fixed to the (grid) ceiling.

MATERIAL PROPERTIES

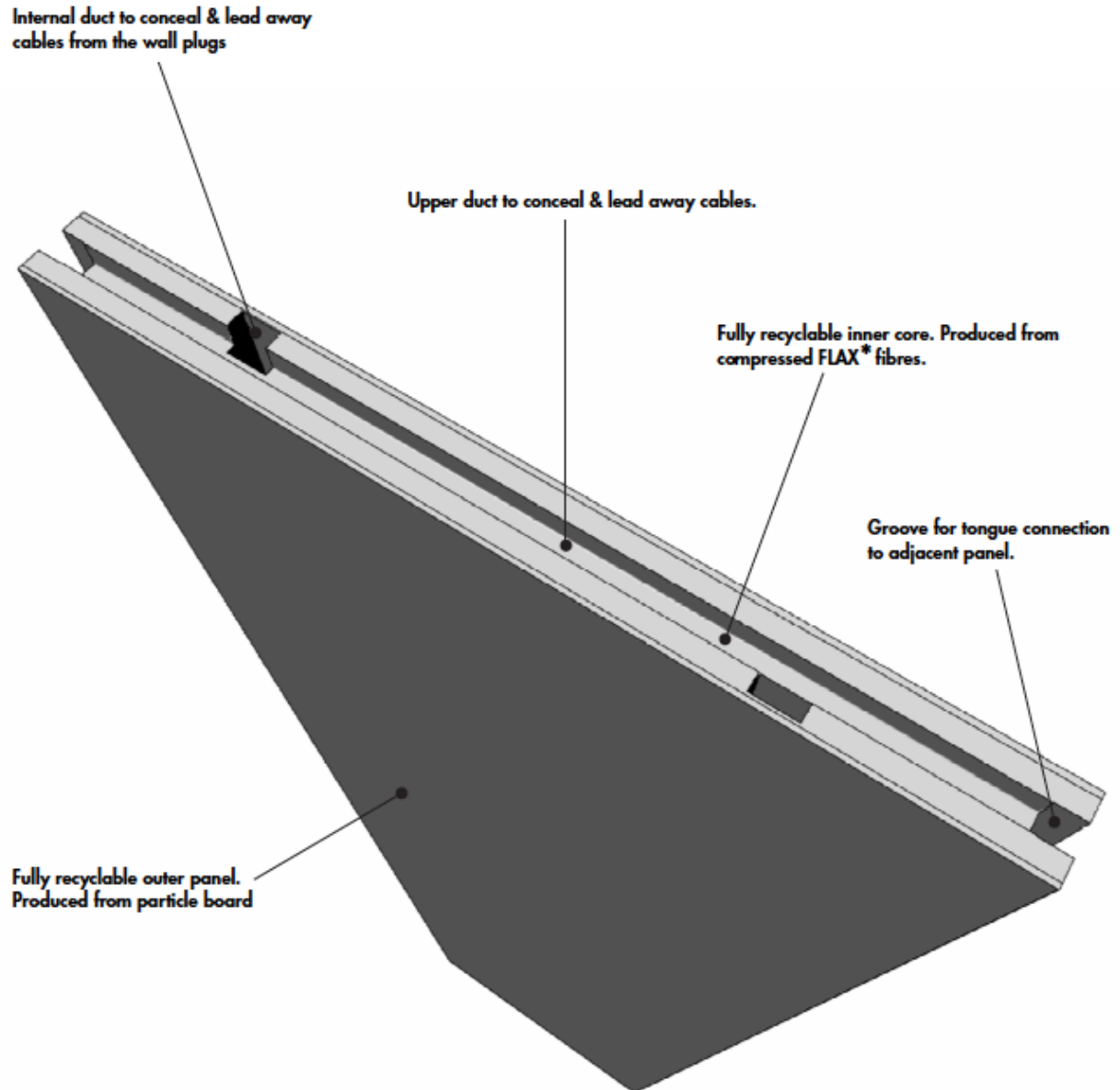

thegoodpeople.se

